



WET-445 RAGLESS IMPELLER

Sharpe Mixers' WET-445 Ragless Impeller is engineered to perform for the demanding service of wastewater and industrial applications with fibrous material that may build up on the equipment. The heavy duty, adjustable, efficient, self-cleaning axial flow design allows positive flow from top to bottom that will keep the shaft and impeller free of debris.

Standard Features:

- High quality stainless steel construction
- One piece or split design
- Four blade design for higher pumping rates
- Retrofit or drop in replacement for existing mixers

Additional Benefits:

- Reduced plant operating cost and downtime/premature failure
- Improved mixing performance
- Prevents overloading, shaft failure, and broken blades
- Energy efficient easy to clean design

Advantages of using an ragless impeller:

- High flow design
- Self-cleaning impeller for "Rag Free" agitation
- Trouble-free operation with reliable results
- Improved life cycle costs

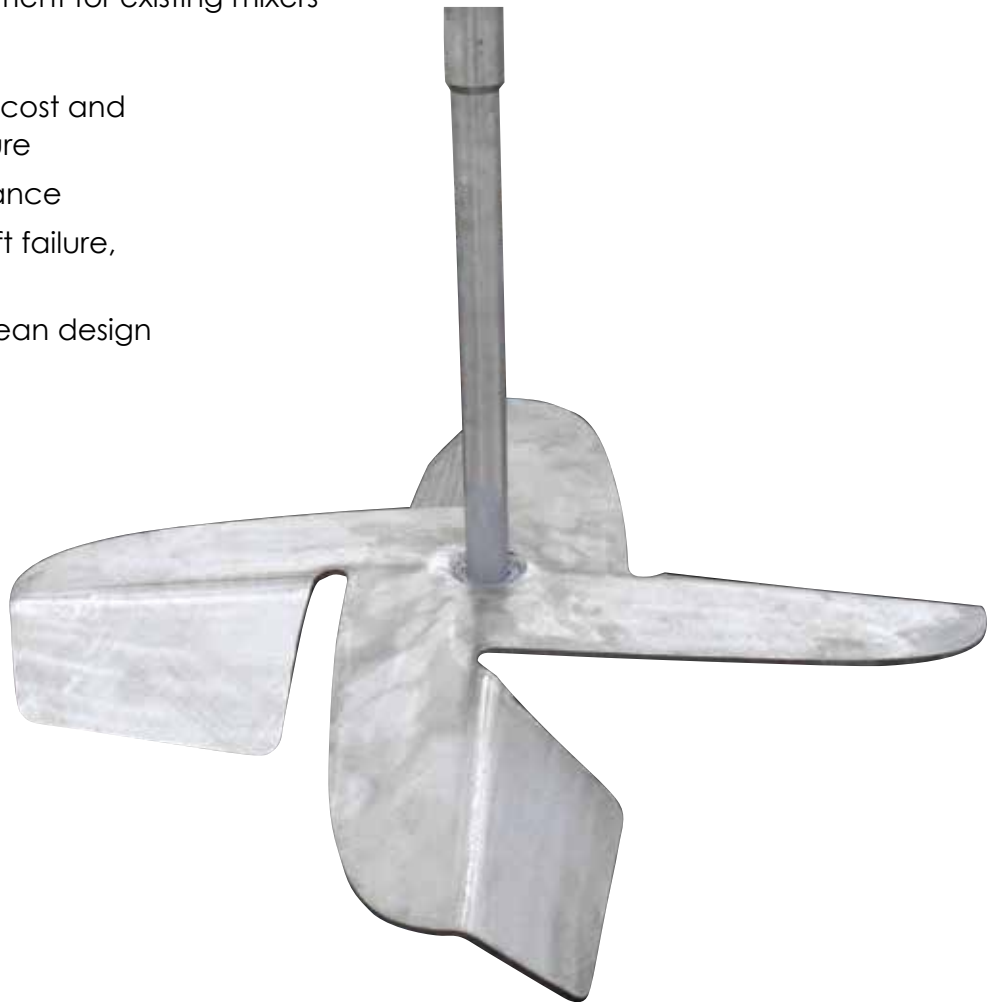

“Rag-Free” Impeller

The WET-445 Ragless Impeller is a cost effective solution that performs similar to a hydrofoil impeller without the ragging issue that can foul the impeller leading to poor performance, costly repairs, and downtime.

The fibers mat together and accumulate over operating time, fouling the impeller, reducing the efficiency and performance. The WET-445 Ragless Impeller design reduces the accumulation of debris on the shaft and impeller blades.



Sharpe's WET-445
Ragless Impeller



Build up example of other
“Rag-Free” impellers

TYPICAL MIXING

Industries

- Pulp & Paper
- Municipal
- Waste Treatment
- Mining

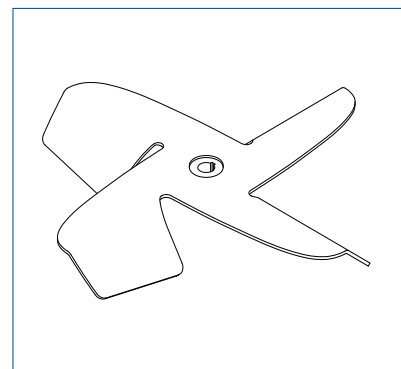
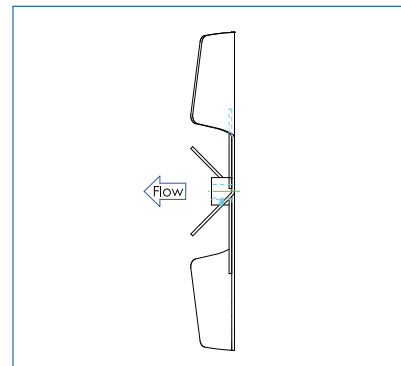
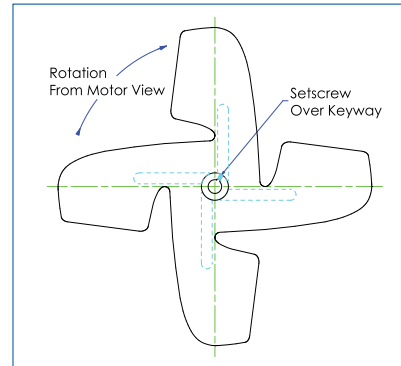

Patent pending

